

QuietClip™ CIC

Channel Isolation Clip

A resilient sound isolation clip engineered for structural isolation in drywall wall and ceiling assemblies.

QuietClip™ CIC features a unique, proprietary low dynamic stiffness rubber bearing, designed for maximum deflection and superior fire performance. The integrated steel failsafe ensures proper compression during installation to maximize isolation efficiency.

- Utilizes Low Dynamic Stiffness Elastomer
- Integrated Structural Failsafe
- Superior Fire & Smoke Performance

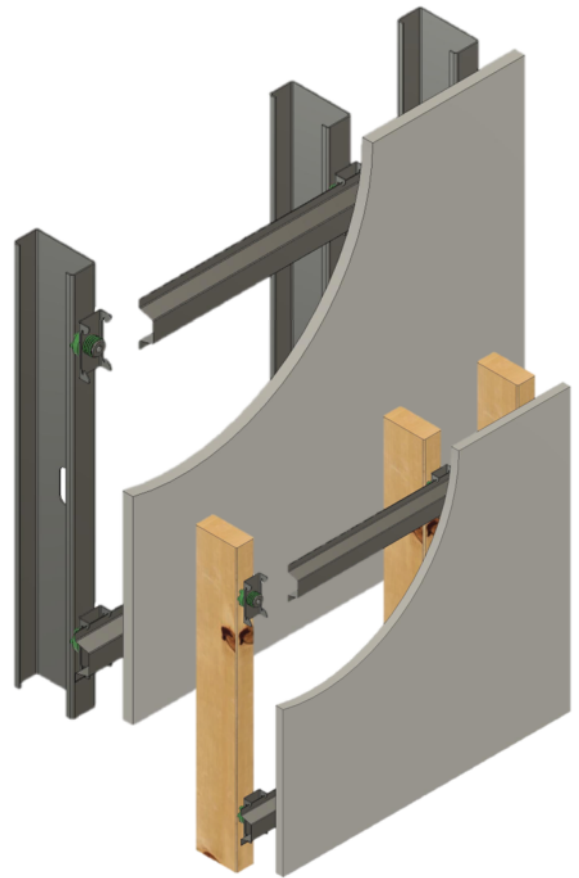

QuietClip™ CIC Benefits

- ✓ 36 lbf/clip Acoustical Design Load
- ✓ Low Dynamic Stiffness Isolator
- ✓ Integrated Failsafe for Perfect Compression
- ✓ Non-Flammable Specialty UL-94 Rubber

QuietClip™ CIC

Channel Isolation Clip

Specification:

Total Deflection:	1/4" (6mm)
Resulting Cavity:	1-5/8"
Acoustical Design Load:	36 lbf/clip
Fire Performance:	UL-94 V0 Elastomer
Suitable for Walls:	yes
Suitable for Ceilings:	yes
Compatible with:	7/8" 25 ga. furring hat channel, hemmed edges

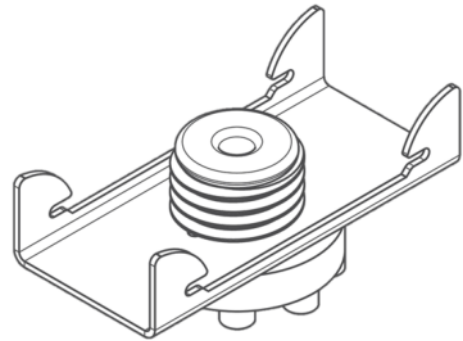

Fastener Specification:

Wall Installation:	wood frame:	#8 x 2-1/2" coarse thread
	steel frame:	#8 x 1-5/8" self-tapping fine thread screws
Ceiling Installation:	wood joist:	#8 x 3" coarse thread
	steel frame:	#8 x 2" self-tapping fine thread screws

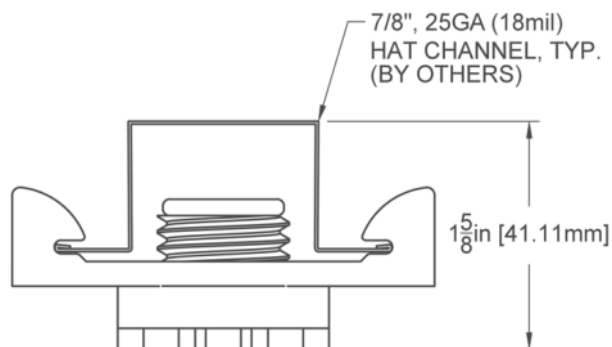

QuietClip™ CIC

Channel Isolation Clip

Layout guidelines, details, and installation instructions are available on our website. Tailored and project-specific details are available upon request.

Staggered Installation Guide for 1-2 Layers of Drywall

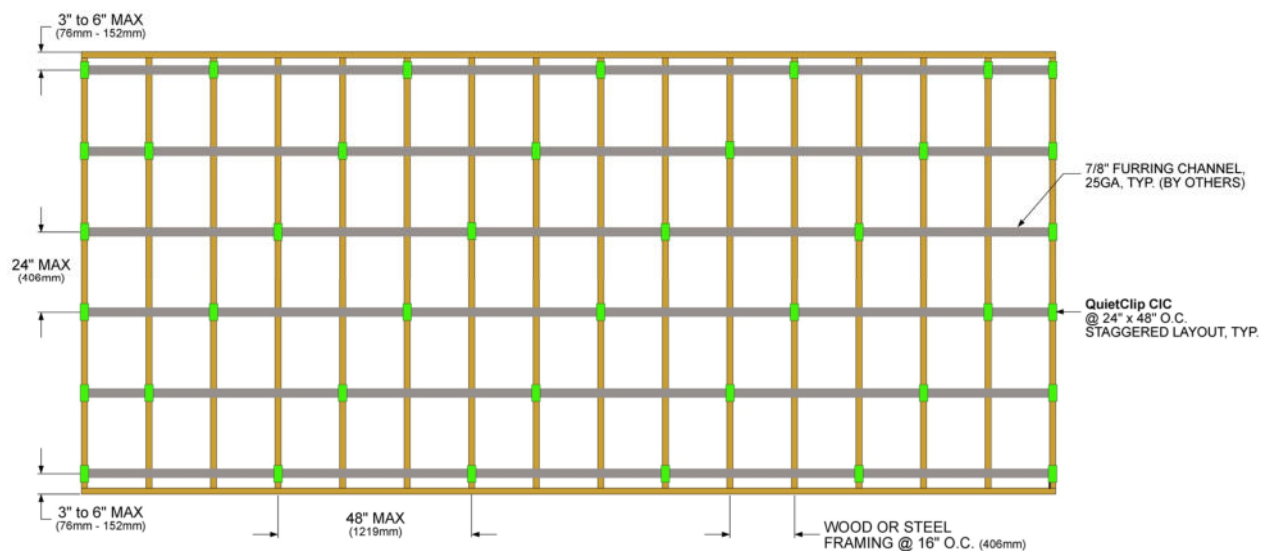

Installation Guide with Door and Window Penetrations

